



BUTLER THERMAWALL™ FLUTED, FINELINE, & FLAT WALL SYSTEMS

Create a uniform, attractive appearance with enhanced thermal performance.

Available in three distinctive panel profiles, the Butler Thermawall™ wall system enables you to create an aesthetically pleasing building exterior with the added benefit of enhanced energy efficiency inside. It is a factory-insulated wall system with concealed fasteners for a clean, attractive appearance.

The Butler Thermawall wall system is ideal for virtually any commercial or industrial application, from architectural applications to cold-storage facilities.

CHOOSE YOUR DESIRED LOOK

You have extensive design flexibility with the Butler Thermawall wall system. Fluted panels create an exterior surface with deep corrugations. Fineline panels create shallow corrugations. And Flat panels create a smooth embossed exterior surface ideal for high-profile architectural applications. Each features a durable Butler-Cote™ fluoropolymer finish with a Kynar 500® or Hylar 5000® coating. The metal interior face is an attractive, virtually flat finish with a polyester white color and is USDA approved.

ACHIEVE ENERGY EFFICIENCY

The Butler Thermawall wall system's factory-installed poured-in-place foam core insulation and thermal break joint design deliver excellent energy efficiency. Panel thicknesses of 2, 2-1/2, 3, and 4 inches are available to match your thermal performance needs, with R-values ranging from R-14 to R-32. Factory-applied joint sealant provides a complete wall system weather barrier.

INSTALLATION IS FAST AND EASY

Because only a clip and two fasteners are required at each structural connection, installation of the

Butler Thermawall wall system is simple and secure. The entire installation is performed from outside the building envelope, eliminating the need for erection crews to fasten the panels from the inside. The 42-inch panel width (Fluted and Fineline) also helps save installation time and cost.

FIRE-RATED ASSEMBLIES

Additional performance benefits are built into the Butler Thermawall wall system. One- or two-hour fire resistance ratings are achievable with Butler Thermawall systems, and they are also FM Global approved—which can help lower insurance costs.



FLUTED PANELS

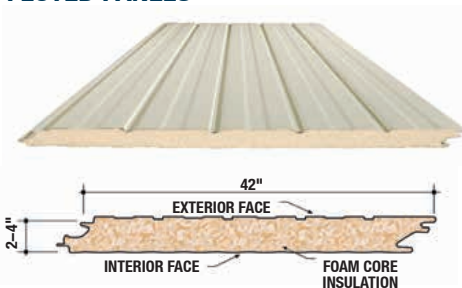

FINELINE PANELS

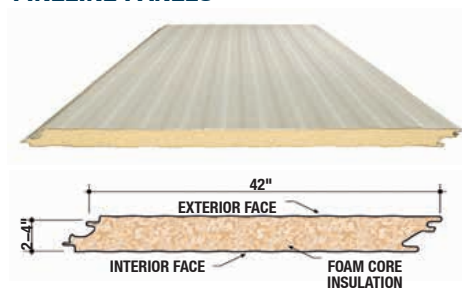

FLAT PANELS

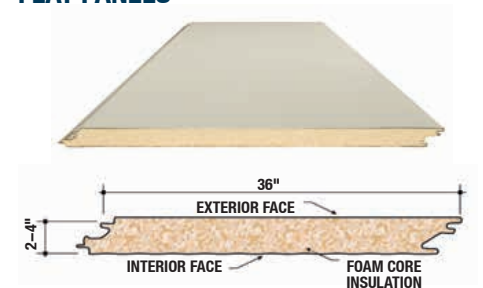

THERMAWALL™ WALL SYSTEM

PANEL-TO-STRUCTURE ATTACHMENT

Thermal break joint to enhance energy efficiency

Attractive exterior appearance



Available in Fluted, Finline, or Flat

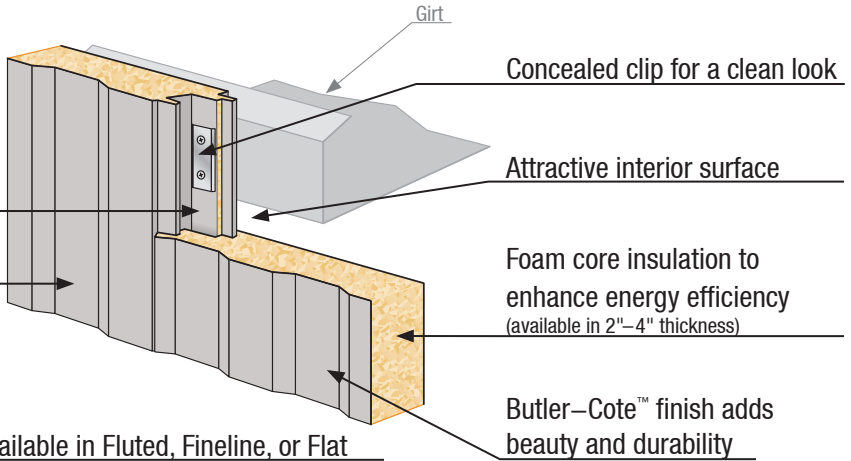

KEY BENEFITS

- ✓ Attractive exterior appearance with concealed fasteners
- ✓ Available in Fluted, Finline, or Flat panel configuration
- ✓ Enhanced thermal performance with high R-values (Up to R-32)
- ✓ Attractive interior metal panel provides a great finish without the need for additional materials
- ✓ Features the Butler-Cote™ finish system warranted to last 25 years
- ✓ FM Global approved
- ✓ 1- to 2-hour UL fire resistance ratings are achievable



BUTLER OFFERS YOU MORE

Butler Builders provide complete construction services with single-source responsibility

- Reputable professionals with extensive knowledge of local building codes

Maximize your building's performance with a complete Butler® system solution

- Innovative structural, wall, and roof systems
- Precision engineered for seamless integration



Butler Manufacturing
Kansas City, MO
816-968-3000

Butler Buildings Canada
Burlington, ON, Canada
905-332-7786

www.butlermfg.com



Butler® building products are constantly being improved; therefore, the information contained herein is subject to change without notice. Before finalizing project details, contact your nearest Butler Builder® or Butler Manufacturing™ for the latest information. Galvalume is a registered trademark of BIEC International, Inc. USGBC logo is a registered trademark owned by the U.S. Green Building Council and is used by permission. IAS is a subsidiary company of the International Code Council. The ENERGY STAR name and the ENERGY STAR symbol are registered trademarks of the United States Environmental Protection Agency.

© 2017 BlueScope Buildings North America, Inc. All rights reserved. Butler Manufacturing™ is a division of BlueScope Buildings North America, Inc. Find your independent Butler Builder® at www.butlerbuilder.com.

Form No. 5417 03/17