



# eSTYLWALL™ FLAT WALL SYSTEM

Combine architectural appeal with energy efficiency in new and retrofit applications.

Through concealed fastener construction and an embossed stucco pattern, the eStylWall™ flat wall system from Butler Manufacturing™ creates an exterior aesthetic that adds to any facility’s curb appeal. Enhanced energy efficiency makes the system an ideal choice for new and retrofit applications.

Choose the eStylWall flat wall system to add functional beauty and further the sustainability of community, commercial and industrial facilities.

## UNIQUE DESIGN DELIVERS THERMAL EFFICIENCY

A one-inch Thermax® insulation board begins the eStylWall™ flat wall system’s insulating properties and also maintains panel flatness. The insulation board is factory-applied, reducing the amount of added insulation and saving on the in-place cost of the system. In addition, thermal spacer blocks are field-applied to the panel at the structural fastening location. Through the patented design of pairing thermal spacer blocks and fiberglass insulation with a vapor barrier, the eStylWall flat wall system can achieve an R-value of 26.3 (equivalent to a tested U-factor of 0.038). All thermal values are tested and validated using the accredited Guarded Hot Box testing lab at the Butler® Research and Development Center.

### TESTED U-FACTOR/R-VALUE CHART

The chart below details the tested U-factors and associated R-values that can be achieved with the eStylWall flat wall system.

Wall Assembly	Tested U-Factor	Effective R-Values
Standard StylWall® II Flat R-19	.060	16.7
eStylWall Flat R-16 Assembly	.059	16.9
eStylWall Flat R-19 Assembly	.047	21.3
eStylWall Flat R-25 Assembly	.038	26.3

## DESIGNED FOR EVOLVING ENERGY CODES

The eStylWall flat wall system is designed to help buildings meet evolving energy codes, which serve as the foundation of many state energy



requirements in the eight climate zones across the United States.

## FOR BEAUTIFUL BUILDINGS OF ALL TYPES

A monolithic appearance is created through the eStylWall flat wall system’s 16-inch-wide panels with concealed fasteners. The uniform exterior appearance adds visual appeal to buildings of all types and sizes.

## BEAUTY MEETS DURABILITY

All eStylWall flat wall system panels feature the Butler-Cote™ premium finish. Made with a 70 percent Kynar 500® or Hylar 5000® resin and carrying a 25-year warranty, this incredibly durable Fluoropolymer finish is the finest factory-applied finish in the industry.



eStylWall panels lock together concealing fasteners and providing fast installation and a uniform exterior appearance.

# eSTYLWALL™ FLAT WALL SYSTEM

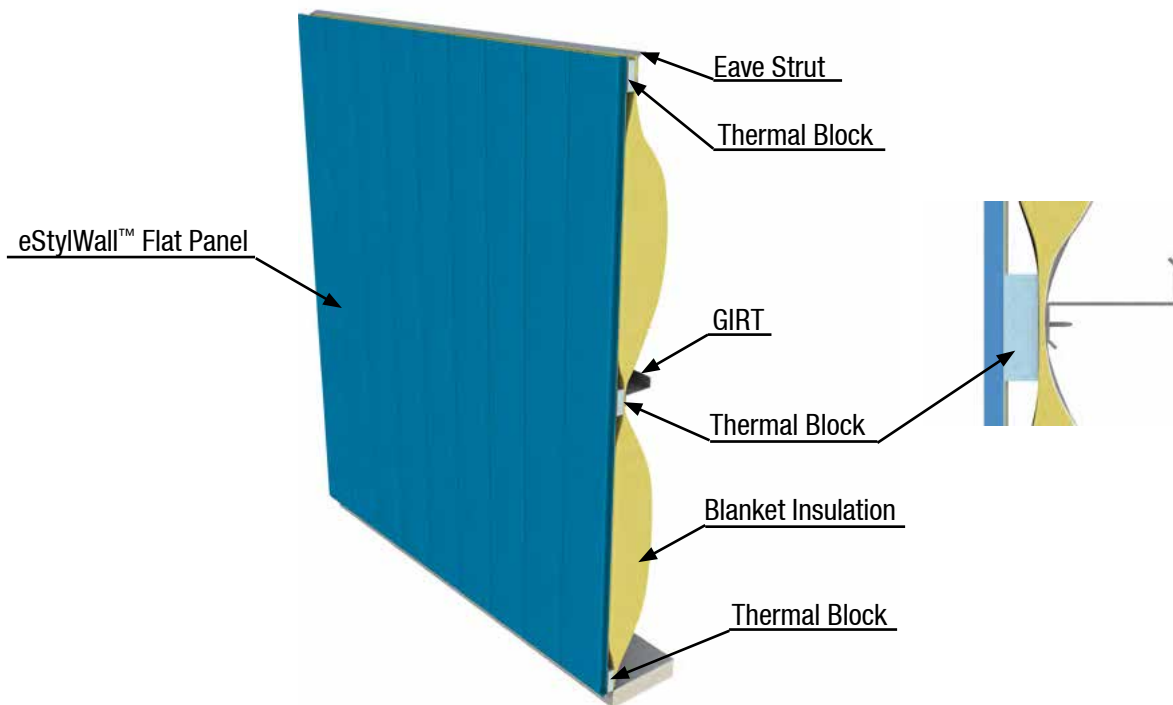

## KEY BENEFITS

- ✓ Energy efficiency is enhanced through the unique assembly design of the eStylWall flat wall system, including thermal spacer blocks and fiberglass blanket insulation.
- ✓ Thermax insulation board further increases energy efficiency.
- ✓ Concealed fasteners create a smooth, monolithic exterior.
- ✓ High-performing Butler-Cote™ 25-year fluoropolymer finish resists chalking and fading.
- ✓ Versatile system can be used with Butler roof and structural systems for all building types.

## BUTLER OFFERS YOU MORE

Butler Builders provide complete construction services with single-source responsibility, along with an extensive knowledge of local building codes.

Maximize your building's performance with a complete Butler® system solution

- Innovative structural, wall, and roof systems
- Precision engineered for seamless integration



Butler Manufacturing  
Kansas City, MO  
816-968-3000

Butler Buildings Canada  
Burlington, ON, Canada  
905-332-7786

[www.butlermfg.com](http://www.butlermfg.com)



Butler® building products are constantly being improved; therefore, the information contained herein is subject to change without notice. Before finalizing project details, contact your nearest Butler Builder® or Butler Manufacturing™ for the latest information. Kynar 500® is a registered trademark of Arkema. Hylar 5000® is a registered trademark of Solvay Solexis. The USGBC logo is a registered trademark owned by the U.S. Green Building Council and is used by permission. IAS is a subsidiary company of the International Code Council. The ENERGY STAR name and the ENERGY STAR symbol are registered trademarks of the United States Environmental Protection Agency.

© 2016 BlueScope Buildings North America, Inc. All rights reserved. Butler Manufacturing™ is a division of BlueScope Buildings North America, Inc. Find your independent Butler Builder® at [www.butlerbuilder.com](http://www.butlerbuilder.com).

Form No. 5516 3/16