



eSTYLWALL™ FLUTED WALL SYSTEM

Create a visually striking exterior while enhancing the energy efficiency of your building's interior.

If architectural appeal and energy efficiency are leading concerns, the eStylWall™ fluted wall system, offered by Butler Manufacturing™, is the optimum solution. Distinguish your building through an attractive ribbed design, which creates a dramatic shadow effect on the exterior of your building.

Prepare for anticipated changes to energy codes, including the International Energy Conservation Code® and ASHRAE® Standard 90.1, with this high-efficiency wall system.

The eStylWall Fluted wall system is ideal for new or retrofit building applications, including community, commercial and industrial facilities.

ARCHITECTURAL FLAIR

To achieve a striking exterior aesthetic, the eStylWall™ fluted wall system features a deep-ribbed design with concealed fasteners. Interesting shadows are produced by changing light conditions, adding visual interest to buildings of all types and sizes.

DESIGNED FOR EFFICIENCY

The eStylWall fluted wall system is both a cost- and energy-efficient solution. With a patented design, thermal spacer blocks are field-applied at the structural fastening locations — not only reducing thermal short circuits where insulation is compressed but also adding depth to accommodate thicker layers of insulation. Through the use of thermal spacer blocks and fiberglass insulation with a vapor barrier, a tested U-factor of 0.051 (effective R-value of 19.5) can be reached. All thermal values are tested and validated using



the accredited Guarded Hot Box testing lab at the Butler® Research and Development Center.

ADAPTING TO EVOLVING ENERGY CODES

The eStylWall fluted wall system is designed to help buildings comply with the International Energy Conservation Code and ASHRAE Standard 90.1, which serve as the foundation of many state energy code requirements in the eight climate zones across the United States.

ENSURING LONG-LASTING BEAUTY

The eStylWall fluted wall system uses the high-quality Butler-Cote™ premium finish. Comprised of a 70 percent Kynar 500® or Hylar 5000® resin, this incredibly durable Fluoropon® holds a 25-year warranty against blistering, peeling, cracking or chipping of the paint finish.



The special joint design lets each new panel “snap” easily into place against the previously installed panel.

TESTED U-FACTOR/R-VALUE CHART

The chart below details the tested U-factors and associated R-values that can be achieved with the eStylWall fluted wall system.

Wall Assembly	Tested U-Factor	Effective R-Values
Standard StylWall® II Fluted R-16	.073	13.8
Standard StylWall® II Fluted R-19	.070	14.2
eStylWall Fluted R-19 Assembly	.057	17.7
eStylWall Fluted R-25 Assembly	.051	19.3

eSTYLWALL™ FLUTED WALL SYSTEM

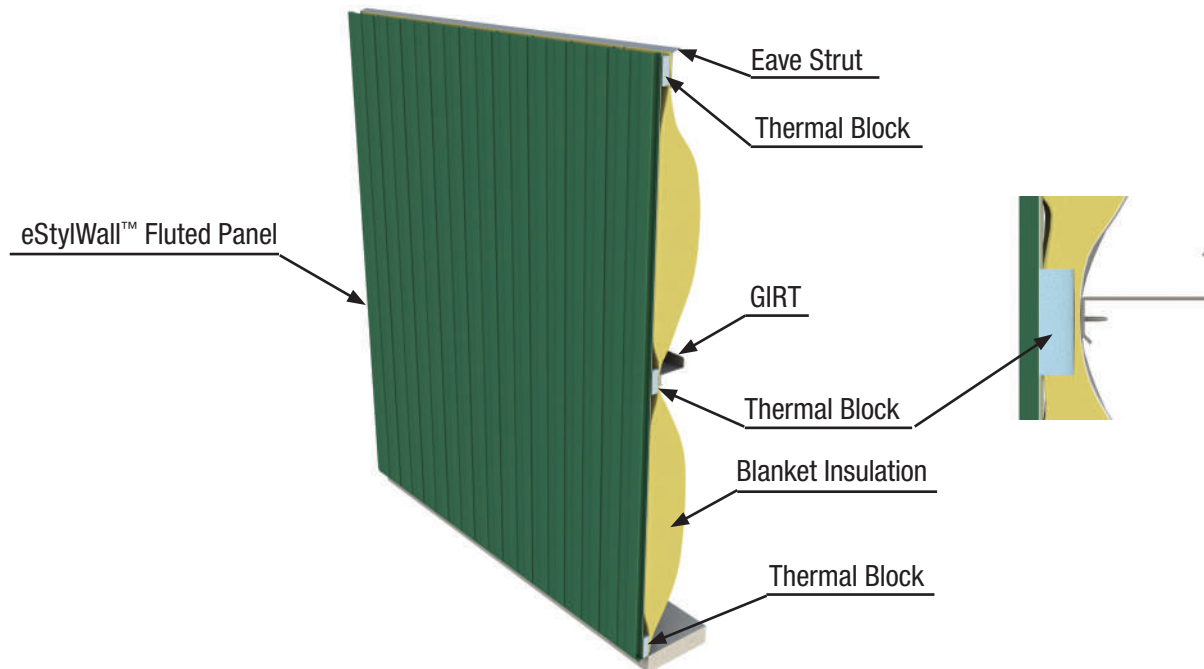

KEY BENEFITS

- ✓ Deep-ribbed exterior wall system is architecturally pleasing and creates unique shadow effects.
- ✓ Concealed fasteners further enhance panel appearance.
- ✓ Enhanced energy efficiency through the unique assembly design of the eStylWall fluted wall system, thermal spacer blocks and fiberglass blanket insulation.
- ✓ High-performing Butler-Cote™ finish system warranted for 25 years against fading and chalking.
- ✓ Available in a range of “cool” colors that carry a Solar Reflective index up to 92.

BUTLER OFFERS YOU MORE

Butler Builders provide complete construction services with single-source responsibility, along with an extensive knowledge of local building codes.

Maximize your building's performance with a complete Butler® system solution

- Innovative structural, wall, and roof systems
- Precision engineered for seamless integration



Butler Manufacturing
Kansas City, MO
816-968-3000

Butler Buildings Canada
Burlington, ON, Canada
905-332-7786

www.butlermfg.com



Butler® building products are constantly being improved; therefore, the information contained herein is subject to change without notice. Before finalizing project details, contact your nearest Butler Builder® or Butler Manufacturing™ for the latest information. ASHRAE is a registered trademark of the American Society of Heating, Refrigerating and Air-Conditioning Engineers, Inc. Fluoropon® is a registered trademark of The Valspar Corporation Hylar® 5000 is a registered trademark of Solvay Solexis, Inc. Kynar 500® is a registered trademark of Arkema, Inc. International Energy Conservation Code is a registered trademark of the International Code Council, Inc. Thermax™ is a registered trademark of The Dow Chemical Company, (“Dow”) or an affiliated company of Dow.

©2017 BlueScope Buildings North America, Inc. All rights reserved. Butler Manufacturing™ is a division of BlueScope Buildings North America, Inc. Find your independent Butler Builder® at www.butlerbuilder.com.

Form No. 5517 7/17